

A TYPICAL PERIMETER FOOTING
SCALE: NONE

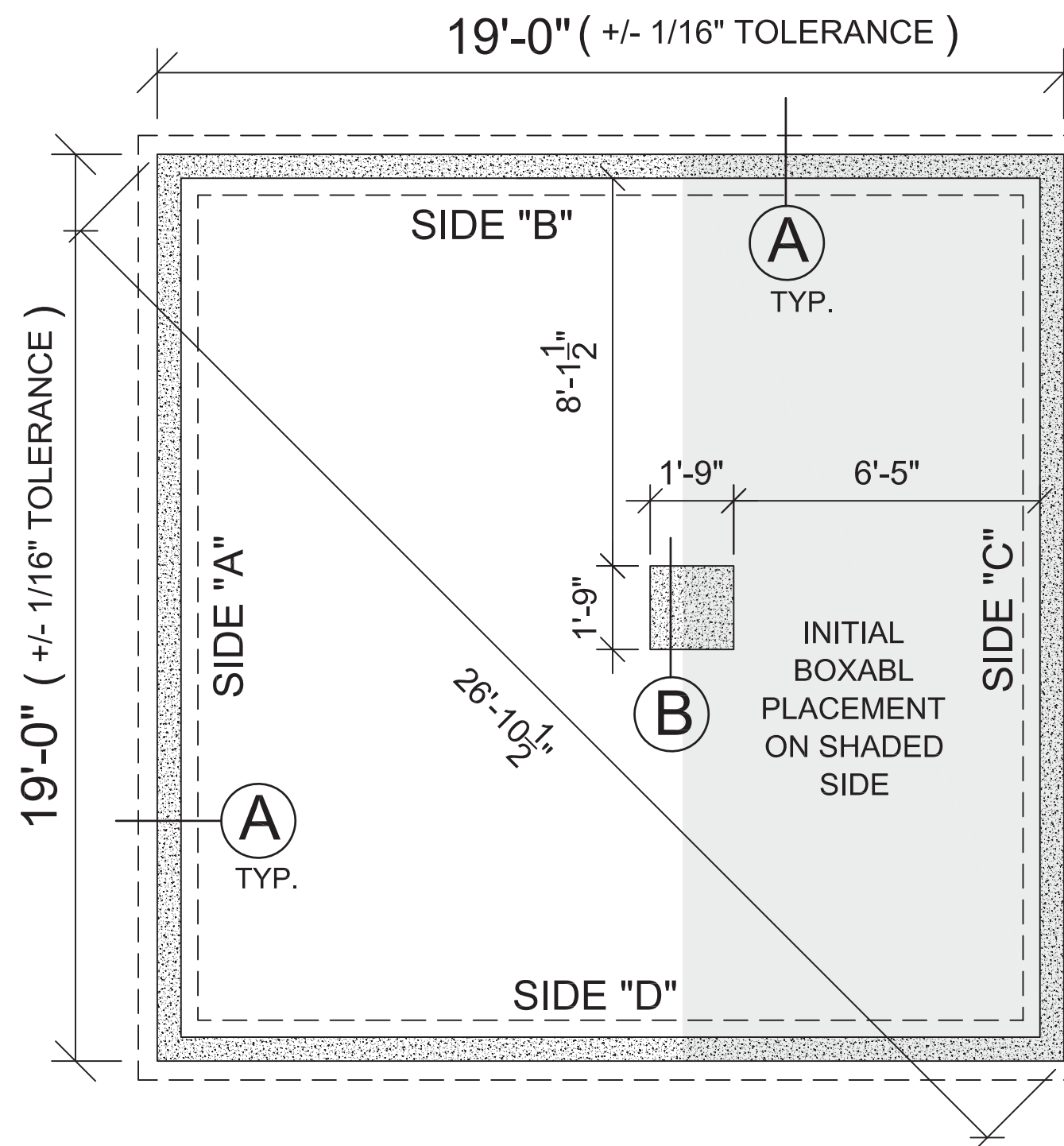

FOUNDATION PLAN

NOTES:

TOP SURFACE OF PERIMETER CONCRETE STEMWALL SHALL BE FLAT AND LEVEL TO WITHIN 1/8" BETWEEN ANY TWO POINTS AROUND THE PERIMETER.

CONCRETE TO HAVE A 28 DAY COMPRESSIVE STRENGTH, $f_c = 2,500$ psi.

REINFORCEMENT TO BE ASTM GR. 40

PROVIDE 90 DEG. BENT #4 BARS w/ 18" LEGS AT CORNERS. TIED TO MAIN. REINF.

1,500 PSF ALLOWABLE SOIL BEARING PRESSURE ASSUMED. FOUNDATION IS NOT SUITABLE WHERE EXPANSIVE SOILS EXIST. OR SOILS SUBJECT TO LIQUEFACTION.

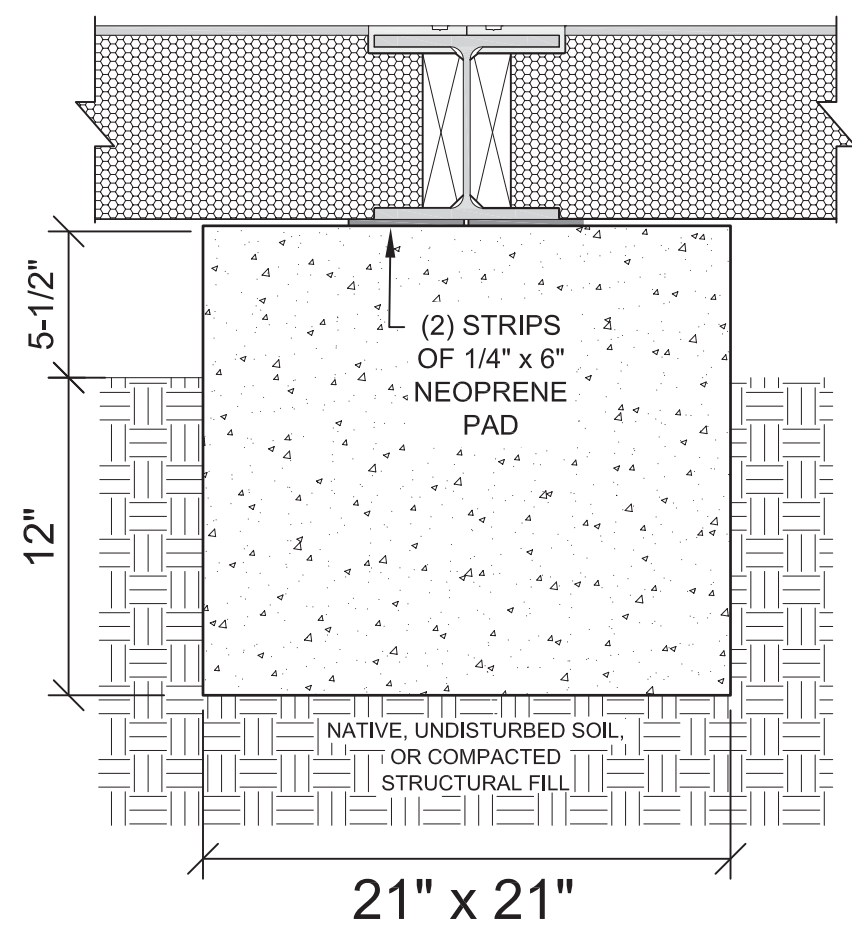

B INTERIOR BEAM SUPPORT
SCALE: NONE

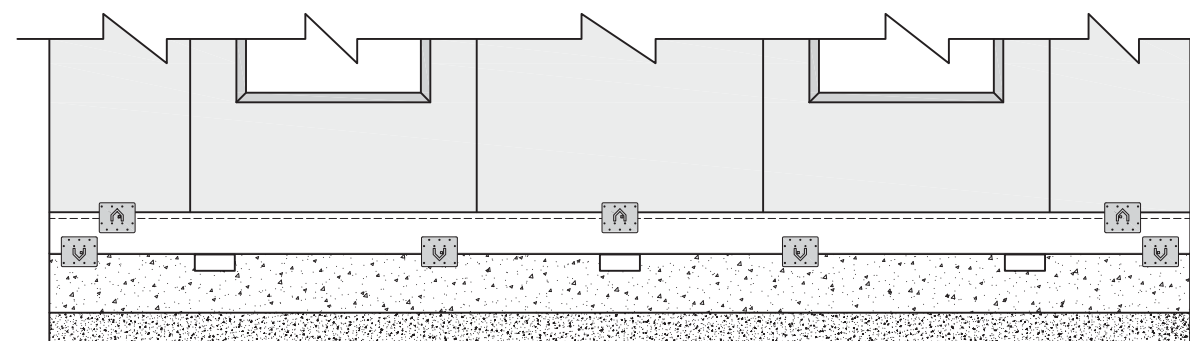

LEFT SIDE

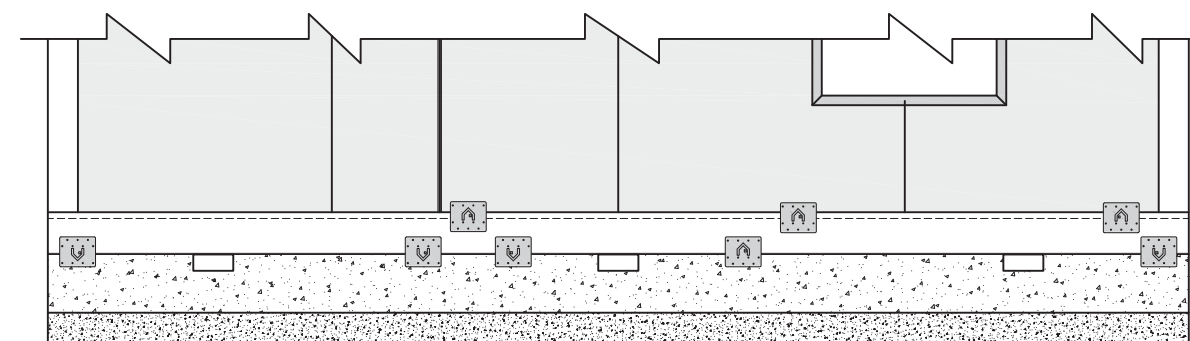

BACK SIDE

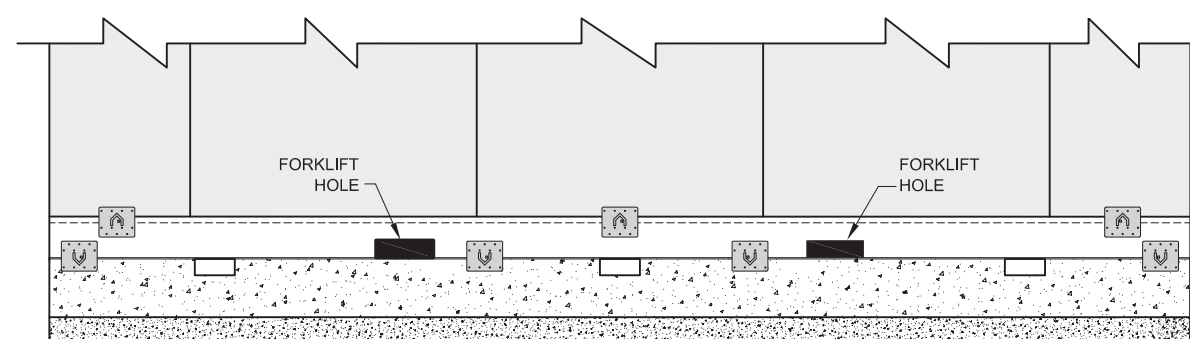

RIGHT SIDE

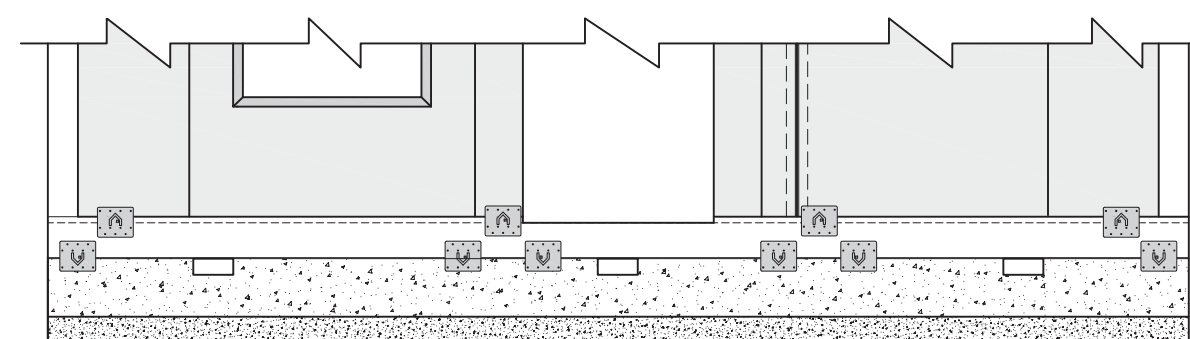

FRONT SIDE

THE SPECIFIC NUMBER AND SPACING OF CONNECTION PLATES SHOWN SHOULD BE CONSIDERED GENERIC & CONCEPTUAL UNTIL DETERMINED BY A LICENSED STRUCTURAL ENGINEER TO ACCOMMODATE LOCAL WIND AND SEISMIC CONDITIONS

LOCATION:

MODEL:
1 STORY BOXABL CASITA

NOTES:

CONCRETE STEMWALL FOUNDATION

CONCEPTUAL, NOT FOR CONSTRUCTION

PROPRIETARY AND CONFIDENTIAL
THE INFORMATION CONTAINED IN THIS DRAWING IS THE SOLE PROPERTY OF BOXABL INC. ANY REPRODUCTION IN PART OR AS A WHOLE WITHOUT THE WRITTEN PERMISSION OF BOXABL INC. IS PROHIBITED.

SCALE: NONE

DRAWN BY: MN

REVIEWED BY:

REVISION DATE:

ISSUE DATE: 10-14-22

SHEET: **F1**